

Summary of the JAMA/JAPIA Standard Material Datasheet version upgrade (for Ver.2.10)

- This document is issued to supply information for JAMA/JAPIA Standard Material Datasheet version upgrade items. (for Ver.2.10)
[Release date : October 1st, 2009]
- The upgraded JAMA/JAPIA Standard Material Datasheet (Ver.2.10) can be downloaded from the JAPIA website (<http://www.japia.or.jp/>) after October 2009.
- The JAMA/JAPIA Standard Material Datasheet may be upgraded in the future.

October 1st, 2009
Japan Auto Parts Industries Association
SoC(Substances of Environmental Concern) WG

File	Upgrade item	Upgrade content	Details
I. Entry file	1. Indication display of SVHC	<p>If user enter the SVHC which was regulated by REACH, the style of character font "italic type" for the purpose of attention to the user.</p> <p>[Object entry item] Substance code (CAS No.) (Item No. : 24) Substance name (Item No. : 25)</p> <p>(Notes) - A substance regulated as SVHC at the JAMA sheet upgrade time become the object. A substance which regulated as SVHC after JAMA sheet upgrade time does not become object. - For general information of REACH, please refer to "Automotive Industry Guideline on REACH (AIG)". This guideline is uploaded in JAPIA web site.</p>	<p>page 6</p>

(continue)

File	Upgrade item	Upgrade content	Details
I. Entry file	2. Add entry item Presence type of process chemical	For harmonization with IMDS, an entry item was added. [Object entry item] Presence type of process chemical (Item No. : 23) (Notes) - The added column is used the the substance group column (item no. : 23) of previous JAMA sheet (Ver.2.03).	page 7
	3. Delete entry item Recycling	For harmonization with IMDS, an entry item was deleted. [Object entry item] none (This column was hidden in Excel.) (Recycling(Item No. : 33), previous JAMA sheet (Ver.2.05))	page 8
	4. Improvement "Select material" screen	"Select material" screen was modified for improvement. - Change the screen layout - Add preview screen "Select material" screen is displayed, when user click the "select" button in the material name cell (Item No. : 13).	page 9

File	Upgrade item	Upgrade content	Details
I. Entry file	5. Improvement “Select substance” screen	<p>“Select substance” screen was modified for improvement.</p> <ul style="list-style-type: none"> - Change the screen layout - Add preview screen <p>“Select substance” screen is displayed, when user click the “select” button in the substance code (Item No. : 24)</p>	page 11
	6. Error check function Substance portion	<p>For harmonization with IMDS, Error check function for judgment of the upper limit value in the wildcard substance portion was changed.</p> <p>[Object entry item]</p> <ul style="list-style-type: none"> Substance portion(Minimum) (Item No. : 42) Substance portion(Maximum) (Item No. : 43) Substance portion(Rest) (Item No. : 44) 	page 13
	7. Cover sheet	<ul style="list-style-type: none"> - “Version No.” and “Date” had been revised. - “Explanation of upgrade” had been added. 	page 14
	8. Description sheet	<ul style="list-style-type: none"> - “Presence type of process chemical” was added. - “Recycling” was deleted. 	page 15

(continue)

File	Upgrade item	Upgrade content	Details
I. Entry file	9. Output button	- Output button was added in entry sheet.	-
II. External list	10. Material list MAT	- The contents of the revision of JIS standard were reflected.	-
	11. Substance list IMDS_SUB	- The alternation of IMDS BSL (addition, correction, and deletion) were reflected. - Substance name (Japanese) and GADSL category were revised.	-

I. Upgrade items for entry file

1. Indication display of SVHC

If user enter the SVHC which is regulated by REACH, the style of character font “italic type” for the purpose of attention to the user.

	24	25
	SUBSTANCE	
	Substance code Select	Substance name
SVHC	<i>84-74-2</i>	<i>DBP</i>
Not SVHC	7439-92-1	Lead

← <Revised>
Display by “italic type”

---> Display by “standard type”
(Same as before)

(Note)

- Font type is changed after an error check.
In case of data input by hand, the font type is not changed at the point of data entry, please be careful.
- The color of font is displayed depend on GADSL category. There is not the relation with SVHC.
Prohibit(P):red, Prohibit/Declarable(P/D):purple, Declarable(D):brown

2. Add entry item (Chemical presence type)

7/16

Item No.	20	23	24
	Substance		
Item	Substance count	Presence type of process chemical	Substance code
Definition	Serial number of declarable substance in each material	Presence type of process chemical	CAS Code of substance
Entered by	supplier	supplier	supplier
Required/Optional		required (In case of entering process chemical and the substance portion is more than 0.1%)	required (In case of entering substance)
Data type	Number	Number ("1" or "2" or "3")	ASCII characters
number of digits (integer number)	3	2	300
number of digits (decimal points)		0	0

<Revised>
Add entry item

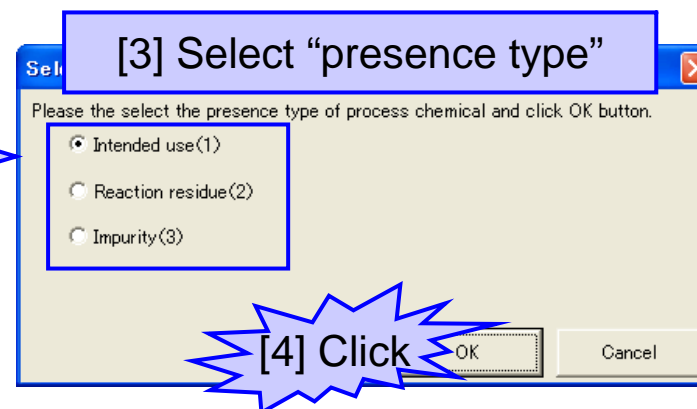

[5] Enter "presence type"

(Notes)

- If entered substance is not process chemical, the column of chemical presence type should be blank. In this case, the error check function delete the entered chemical presence type.
- The added column is used the the substance group column (item no. : 23) of previous JAMA sheet (Ver.2.03).
- Entered chemical presence type is output in XML file. But, if Node ID [material] (Item No. : 46) is entered, entered Presence type of process chemical is not output in XML file.

3. Delete entry item (Recycling)

Item No.	32	34
	RECYCLATE	
Item	Polymeric part(s)	Application Select
Definition	Code of Polymeric marked on component or not	Usage code of substance in regulated in IMDS
Entered by	supplier	supplier
Required/Optional	required (In case of VDA classification is 5.1.a, 5.1.b and Material weight more than 100g or VDA classification is 5.3 and Material weight more than 200g. Enter in only the top row for the same material.)	required (In case of specific substance)
Data type	"Y" or "N" or "N/A"	ASCII characters
number of digits (integer number)	3	10
number of digits (decimal points)	0	0

<Revised>
 Delete the column of Recycling (Item No. : 33)
 (Note) It was hidden in Excel.

(Note)
 - If user import the CSV file created by JAMA sheet Ver.2.05 or before into Ver.2.10, the data in “Recycling” is deleted automatically.

4. Improvement "Select material" screen

Item No.	13
	Material
	Material name
Item	Select
	Click
Definition	Material name applied to a component part
Entered by:	supplier
Required/Optional	required (In case of enter material)
Data type	ASCII characters
number of digits (integer number)	40
number of digits (decimal points)	0

Please enter search criteria and click OK button.

Surface treatment flag:

Material name(EN):

Material name(JP):

Norms/Standards:

Material-No.:

Symbol:

VDA classification:

Search Cancel

Click OK button and the material information is displayed in sub window.
Please note that the material information is overlaid on the main window.

118 materials found.

Surface treatment	Material name(EN)	Material name(JP)	Norms/Standards	Material-No.	Symbol	VDA classification	IMDS node ID
	Electroslag welding solid wires for mild s	-	JISZ3353	YES52		1.1.1	
	Electroslag welding solid wires for mild s	-	JISZ3353	YES60		1.1.1	
	Electroslag welding solid wires for mild s	-	JISZ3353	YES61		1.1.1	
	Electroslag welding solid wires for mild s	-	JISZ3353	YES62		1.1.1	
	High purity aluminium foils A1N90H	-	JISH4170	A1N90H@		2.1.2	
	High purity aluminium foils A1N99H	-	JISH4170	A1N99H@		2.1.2	
	High strength steel plates for pressure v	-	JISG3124	\$		1.1.1	
	High tensile strength steel for tower stru	-	JISG3129	\$		1.1.1	
	High tensile strength steel forgings for t	-	JISG3223	\$		1.1.1	
	High tensile strength steel tubes for tow	-	JISG3474	\$		1.1.1	
	High yield strength steel plates for weld	-	JISG3128	\$		1.1.1	
	Highly Alloyed Steel E11	-	JISC2531	E11		1.1.2	
	Highly Alloyed Steel E31	-	JISC2531	E31		1.1.2	
	Highly Alloyed Steel E32	-	JISC2531	E32		1.1.2	

Preview OK Cancel

<Revised>
Create new button "Preview". Detail information of material is displayed in sub window.

< Preview screen >

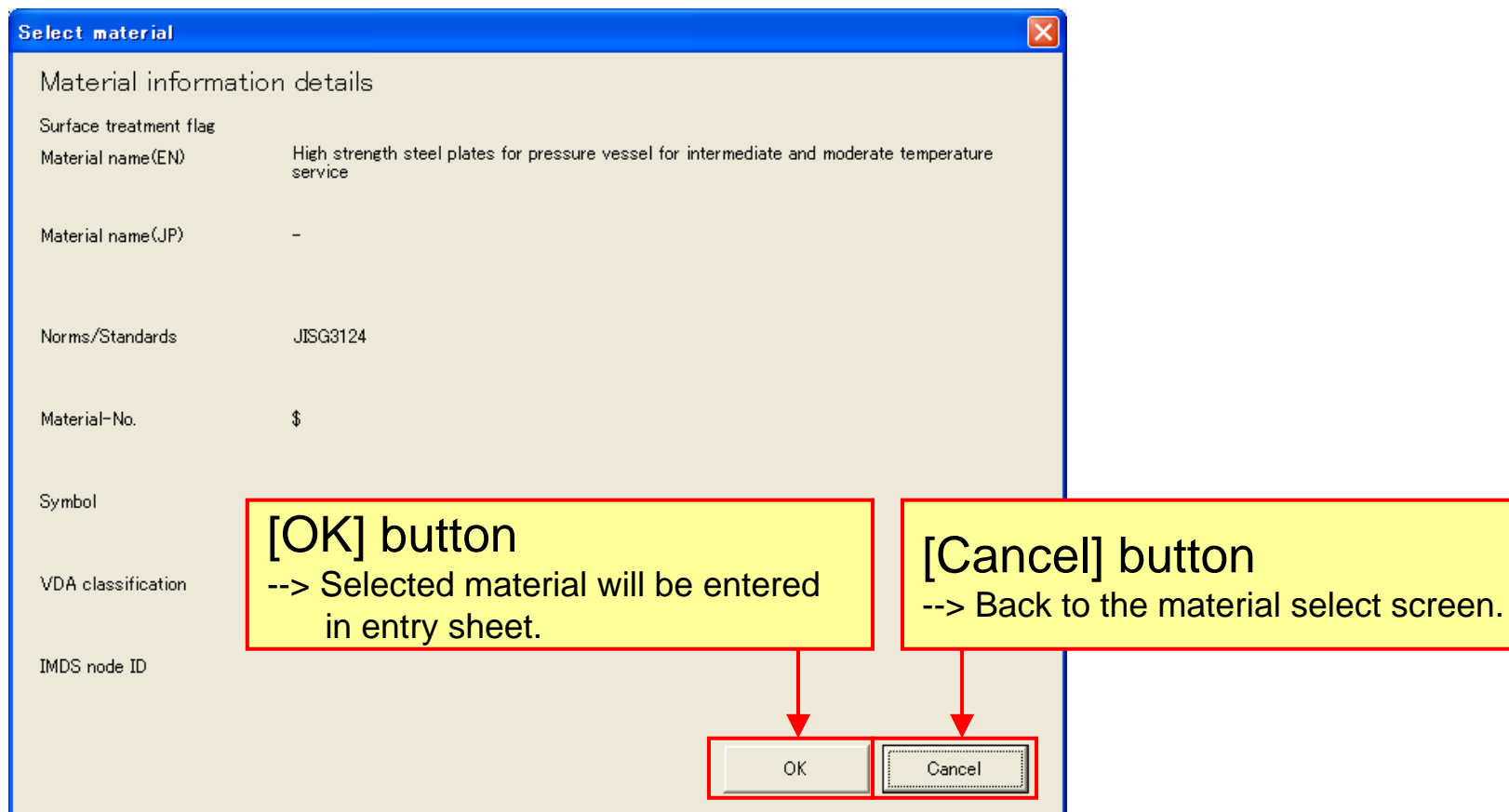

- In the Search result screen, it is sometimes impossible to display the entire material name due to the limitation on the number of letters displayed. In the preview screen, however, it is possible to display all the letters.

5. Improvement "Select substance" screen

Item No. 24

Item SUBSTANCE

Definition Substance code (CAS No.)

Entered by: supplier

Required/Optional required (In case sub)

Data type ASCII c

number of digits (integer number) 300

number of digits (decimal points) 0

Click (on Select button)

<Revised> Change screen layout

<Revised> Add search conditions

<Revised> Reduce indication width

<Revised> Add items

<Revised> Create new button "Preview". Detail information of material is displayed in sub window.

Node ID	declarable (D)	prohibited (P)	SVHC	Process chemical
62				
33192305				
33192305				
7197830				
41260595	Yes	Yes		
106283350				
1060				
79661881				Yes
290				
2119				
2277				
280				
280				

< Preview screen >

The screenshot shows a dialog box titled "Select substance" with a close button (X) in the top right corner. The dialog contains the following fields:

- Substance information details
- CAS No. 38162-93-5
- Substance Name beta-D-erythro-Hex-2-enopyranuronic acid, 4-((3-amino-5-((aminoiminomethyl)methylamino)-1-oxopentyl)amino)-- 1-(4-amino-2-oxo-1(2H)-pyrimidinyl)-1,2,3,4-tetradeoxy-, (S)-, ((phenylmethyl)amino)benzenesulfonate (1:1) (salt)
- Substance Name(JP) -
- Node ID
- declarable(D)
- prohibited(P)
- SVHC
- Process chemical

At the bottom of the dialog are two buttons: "OK" and "Cancel". Two yellow callout boxes with red borders provide instructions:

- [OK] button**
--> Selected substance will be entered in entry sheet.
- [Cancel] button**
--> Back to the substance select screen.

Red arrows point from the callout boxes to the respective buttons.

- In the Search result screen, it is sometimes impossible to display the entire substance name due to the limitation on the number of letters displayed.
In the preview screen, however, it is possible to display all the letters.

6. Error check function (Substance portion)

For harmonization with IMDS, Error check function for judgment of the upper limit value in the wildcard substance portion is changed.

<Object warning>

[mes60:Warning] The wildcard substances more than 10% are contained in the material.

<Condition> Following substance is entered in one material at the same time.

- Wildcard substance : Substance portion (Rest) (Item No. : 44)
 - Not wildcard substance : Substance portion (Minimum) (Item No. : 42) and (Maximum) (Item No. : 43)
- (Note) Wildcard substance : Substance code (Item No. : 24) is defined as “system”.

<Change point> Judgment condition of 10% over or not is changed for following.

Ver.2.05 or before : Automatic entered data in the Substance portion (Item No. : 26)

Ver.2.10 : A difference between 100% and a total value of Substance portion (Minimum) (Item No. : 42) for non-wildcard substances.

<Sample> If user enter the following, the warning message appear in error check.
(There are no warning in previous version.)

	24	25	26	42	43	44
	SUBSTANCE			JAPIA OPTIONS		
	Substance code Select	Substance name	Portion	Substance portion (Minimum)	Substance portion (Maximum)	Substance portion (Rest)
Wildcard	7439-89-6	Iron	90 (Automatic)	85	95	
	system	Misc., not to declare	10 (Automatic)			1

A difference between 100% and the Substance portion (Minimum=85%) of Iron (not wild card) is 15% > 10%.

JAMA Standard Material Datasheet

Ver.2.10
October 1, 2009

Revision of JAMA Standard Material Datasheet is implemented as follows.

<October 1, 2009>
- JAMA and JAPIA issued the revised JAMA Standard Material Datasheet (Ver.2.10), because of adjustment for the IMDS upgrade.
Please refer to the document in JAPIA website for detail information of revision.
- The old external file can not be used, please use the latest external list Ver.2.10(EXLIST-2009-10-01EN.xls).

<June 1, 2009>
- JAMA and JAPIA issued the revised JAMA Standard Material Datasheet (Ver.2.05). Only "external file" is changed, because some substances (ex.Cr3+:Chromium (III) ion) "Entry sheet" does not been changed.

<November 1, 2008>
- JAMA and JAPIA issued the revised JAMA Standard Material Datasheet (Ver.2.04) with the following additional functions
- for the purpose of user convenience and the change in the rule to enter some materials. In this version, some fields identified unnecessary were deleted based on the conventional operational status.
- After November 1, 2008, JAMA and JAPIA will use new JAMA Standard Material Datasheet (Ver.2.04) with the following new functions;

(The rest is omitted.)

Revisions to the JAMA Standard Material Datasheet (Version 2.00)

April 1, 2006
Japan Automobile Manufacturers Association, Inc. (JAMA)
Japan Auto Parts Industries Association (JAPIA)

1. Background

(The rest is omitted.)

<Revised>
Version number and Date have been revised.

<Revised>
Summary of Revision has been added.

(1) Add “Chemical presence type”

Column No	Item name	IMDS field name (XML file attribute name)	Definitions	Notice of data input and explanation	Entered by: - requestor (including automobile manufacturer or Tier1 that requests for investigation) - supplier (that responds to investigation)
23	Presence type of process chemical	Chemical presence type (Element "Substance" Attribute "ProcessChemType")	Presence type of process chemical Process chemical is a substance that is typically consumed or reacted during manufacturing.	- Input following chemical presence type code for process chemical, if the portion is more than 0.1%. Intended use : 1 Reaction residue : 2 Impurity : 3 - If substance is not process chemical, it is not necessary to input.	supplier

Data input method - requestor indicates - enter - select - automatic	Notes	Data type	number of digits (integer number)	number of digits (decimal points)	Data input rules in case of the investigation for materials (may not attached part number) (If the data input rule is not indicated, please follow "Notice of data input and explanation".)
Select		Number	2	0	

(2) Delete “Recycling marked”

(Supplemental remarks)

Data compatibility between Ver.2.10 and Ver.2.05

(1) External list

Not compatible.

Users must use the External list for Ver.2.10.

The external lists for older versions (from Ver.2.00 to Ver.2.05) will not operate normally when using, checking or selecting functions.

(2) CSV file

Compatible.

The JAMA Standard Material Datasheet can import a CSV file created using on older version from Ver.2.00 to Ver.2.05).

However, some errors may occur with the input data of older version because of the modification of a material or substance in the external list.